

No 104.

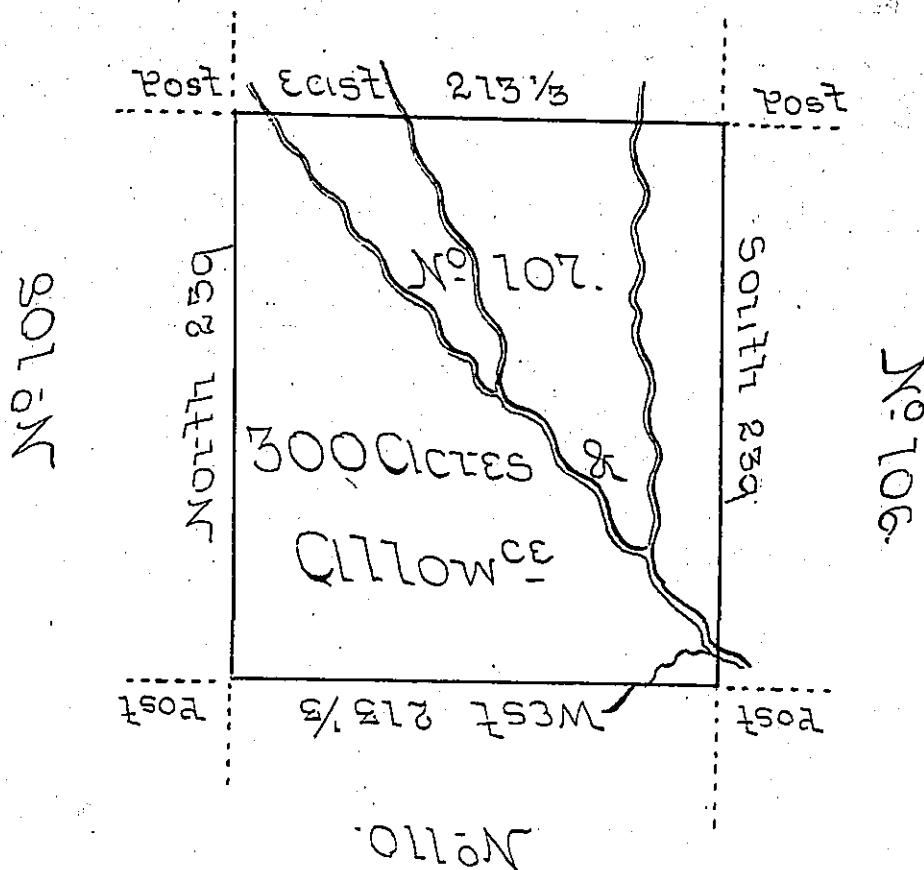

Situate on the Waters of Little Sowekly Creek
 Between the twenty ninth and thirtieth Parallel
 in that Part of District No-10me Allotted on the
 North side of the Ohio being Part of the Land
 Appropriated for the Redemption of the Certifi-
 cates of depreciation &c^a Surveyed in June 1785
 Pursuant to Instructions from Geo. Wilkens
 Esq^r Surveyor Gen^l dated at Philad^a 5th March 1785

Gen^l Breeding U.S

IN TESTIMONY that the above is a copy of the original remaining on file in
 the Department of Internal Affairs of Pennsylvania, made
 conformably to an Act of Assembly approved the 16th day of
 February, 1833, I have hereunto set my Hand and caused
 the Seal of said Department to be affixed at Harrisburg,
 this thirty first day of October 1905.

Geo. A. P. Brown
 Secretary of Internal Affairs.